

<b>Car</b>	MINI Countryman/Paceman R60/R61 Cooper	<b>Part No.</b>	SMNX026
<b>Year</b>	2010-2016	<b>Fit Kits</b>	451FK
<b>Notes</b>	Will also fit JCW Models Where not supplied use original fittings	<b>Features</b>	Pipe Diameter:- 63.5mm

Estimated Fitting Time: 4 Hours

**REMOVE TOP TWO STUDS  
FROM TURBO PRIOR TO  
FITTING SPORTS-CAT TO  
ENABLE EASIER FITMENT**

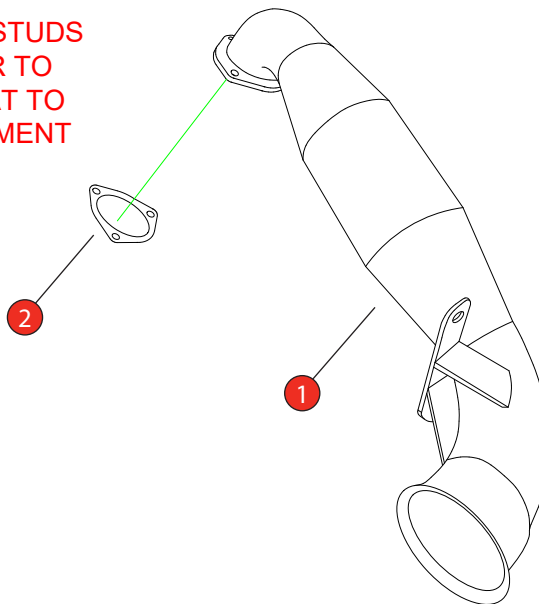

NO.	PART NO.	DESCRIPTION	QTY
1	761BM	High-Flow Sports Cat Downpipe	1
<b>Fit Kit: 451FK</b>			
2	Z033.10071	Gasket	1

CLASSIFICATION	Motorsport Use Only
HOMOLOGATED	No
DATE	08/04/2024
ISSUE	01
AUTHORISED	G. O'Shea

**NOTE:** ENSURE SCORPION SYSTEM IS CLEAR OF MOVING PARTS AND ALL ORIGINAL FUNCTIONS WORK CORRECTLY.

1) Remove the original heat shield prior to removing the original downpipe.

2) Remove the original downpipe retaining all fittings.

3) Fit the Scorpion downpipe using the supplied gasket and original fittings.

4) Once you're happy the downpipe is fitted correctly refit the original heat shield and lambda



STAY CONNECTED TO RED POWER.